

SÉRIE RC

SISTEMA BATENTE RUTURA TÉRMICA 55MM

A série possui como característica principal um sistema de ponte térmica que proporciona uma excelente performance térmica e acústica. Trata-se de um sistema de batente de 54/63mm com câmara europeia e vedação central. É constituída por dois semi perfis de alumínio, unidos por perfis de poliamida. Encontram disponível nas soluções convencional ou decorativa.

Resultados do Ensaio do Tipo Inicial:

Tipo Ensaio	Resultados
Permeabilidade ao Ar	4
Estanquidade à Água	E900
Resistência à Pressão do Vento	C4
Durabilidade Mecânica	-
Coeficiente de Transmissão Térmica	2,4
Desempenho Acústico	28

Janela com perfis alumínio do Sistema RC composta por duas folhas móveis de batente. **Dimensão da Janela:** 1500*1200 mm

Soluções Construtivas:

- Fixos;
- Janelas e Portas;
- Basculantes;
- Projetantes;
- Pivotantes.

Capacidade de Vidro:

- Vidro: 14 a 48mm

Vedantes:

- Material em EPDM ou PVC em conformidade com a norma aplicável.

Acessórios:

- Materiais em alumínio, zamac, aço inox e nylon em conformidade com a norma aplicável.



RC.01 *Aro Fixo*

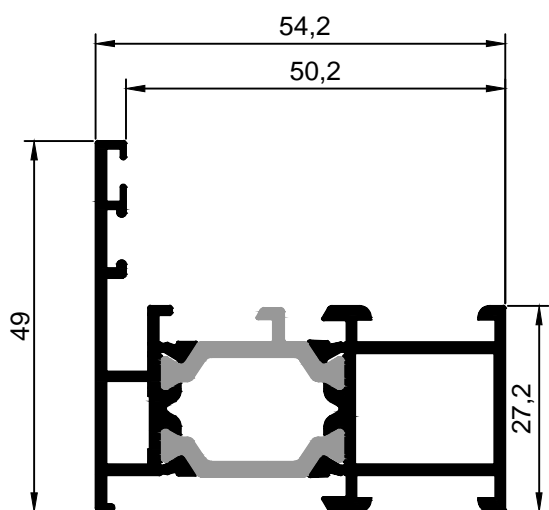

RC.03 *Aro Fixo*

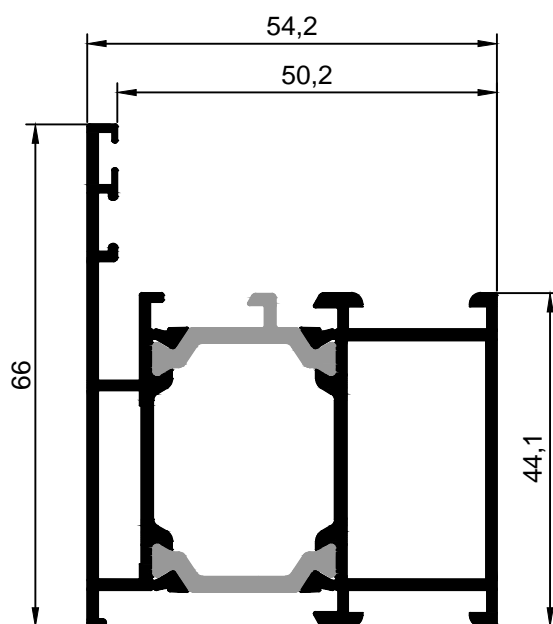

RC.04 *Aro Fixo*

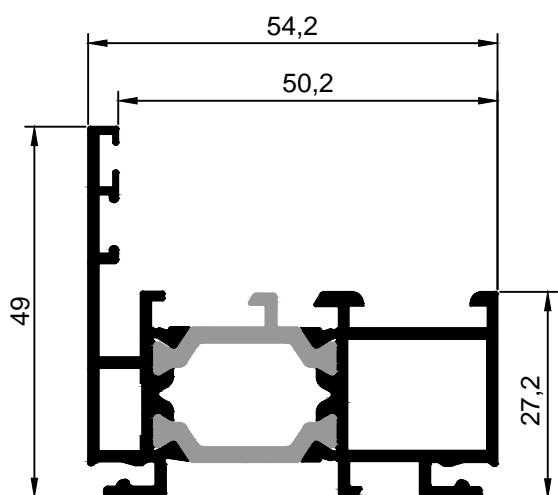

RC.06 *Aro Fixo*

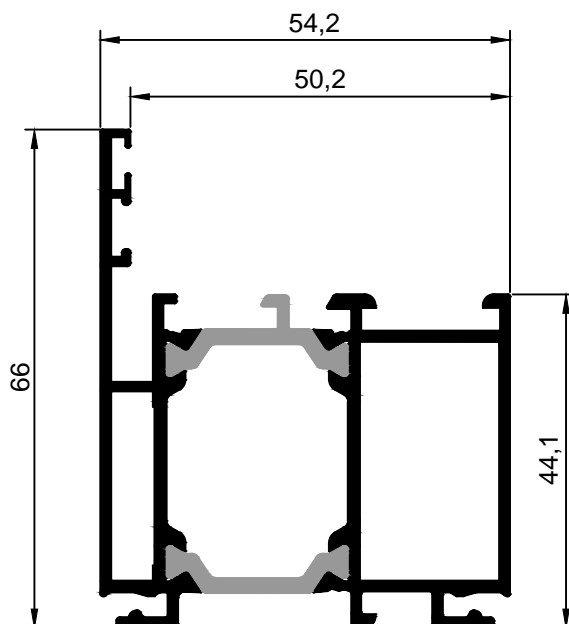

RC.07 *Aro Fixo*

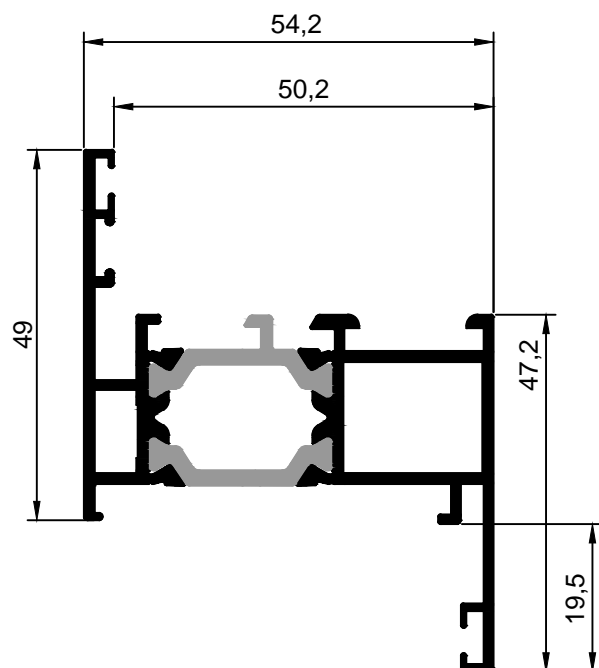

RC.02 *Aro Fixo*

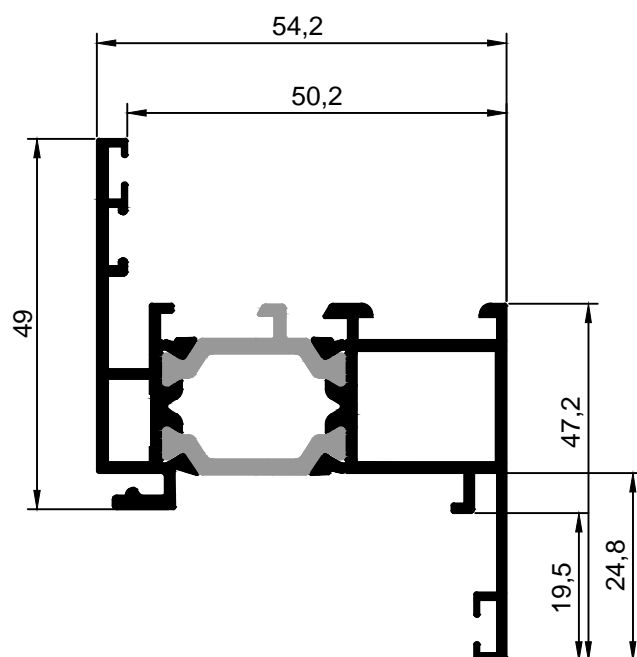

RC.08 *Aro Fixo*

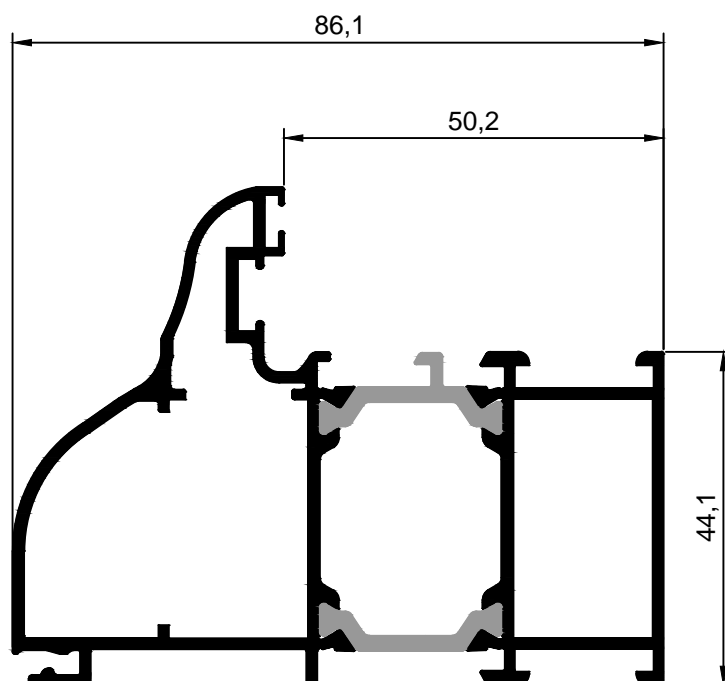

RC.10 *Aro Fixo*

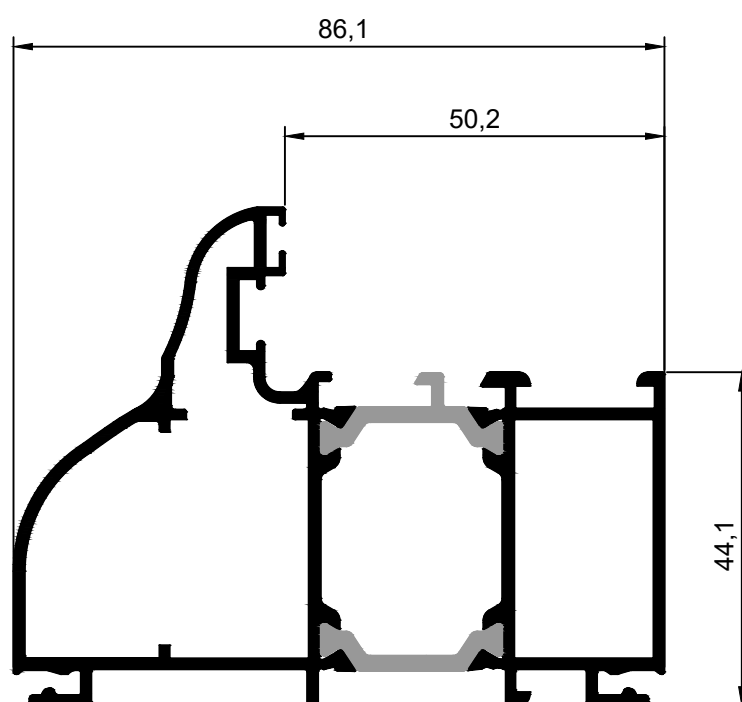

RC.11 *Montante / Travessa*

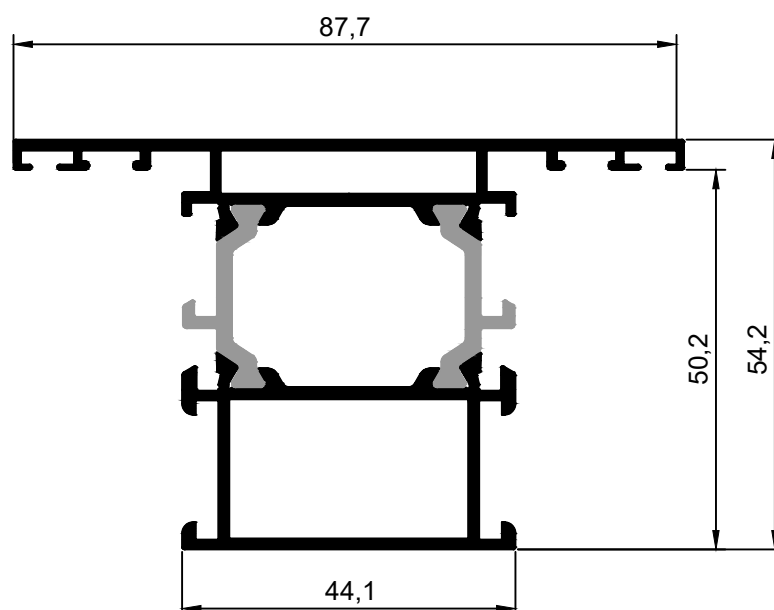

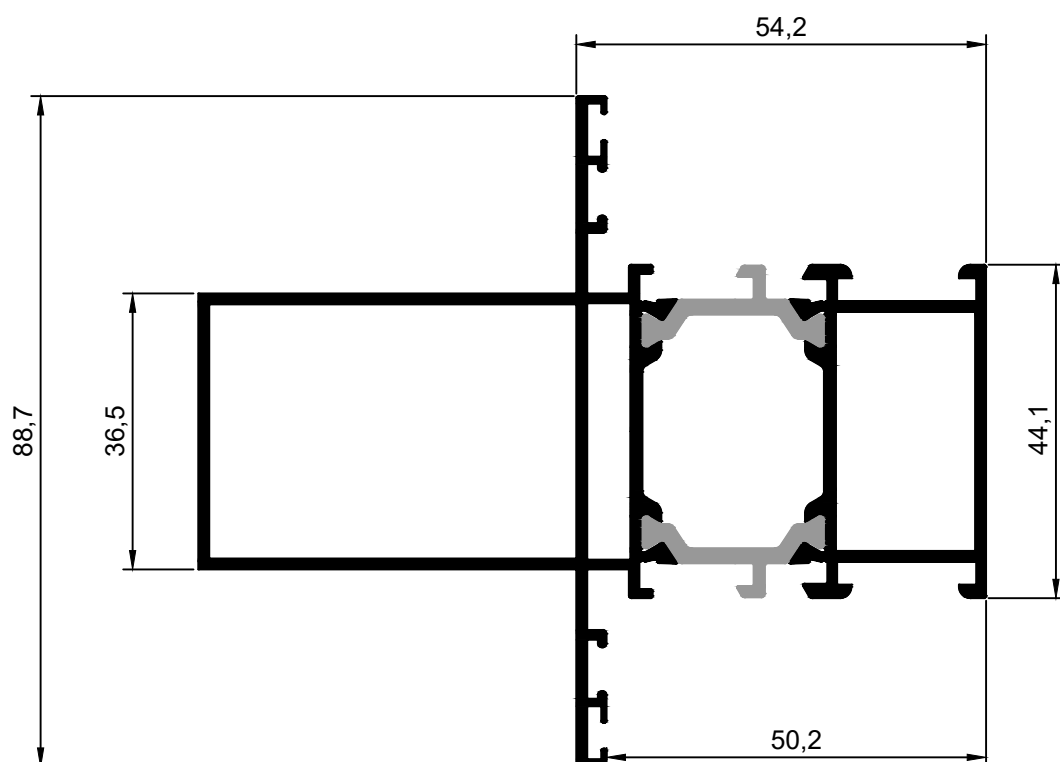

RC.19 *Montante*

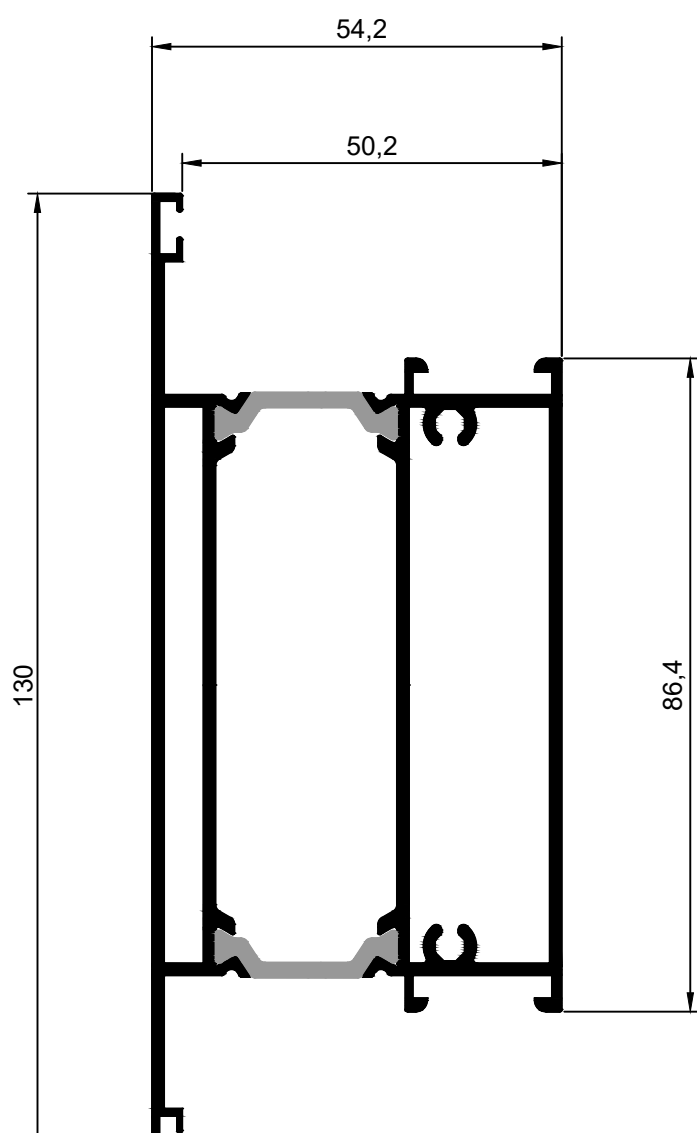

RC.41 *Travessa*

AQ.74 *Bite Vedação Inferior*

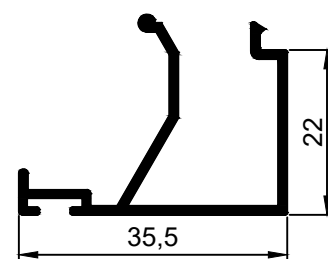

RC.21 Aro Móvel

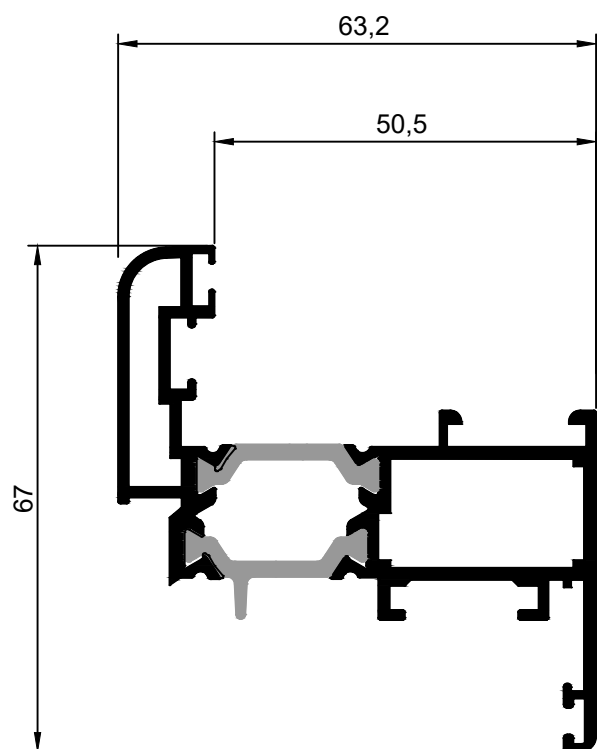

RC.22 Aro Móvel

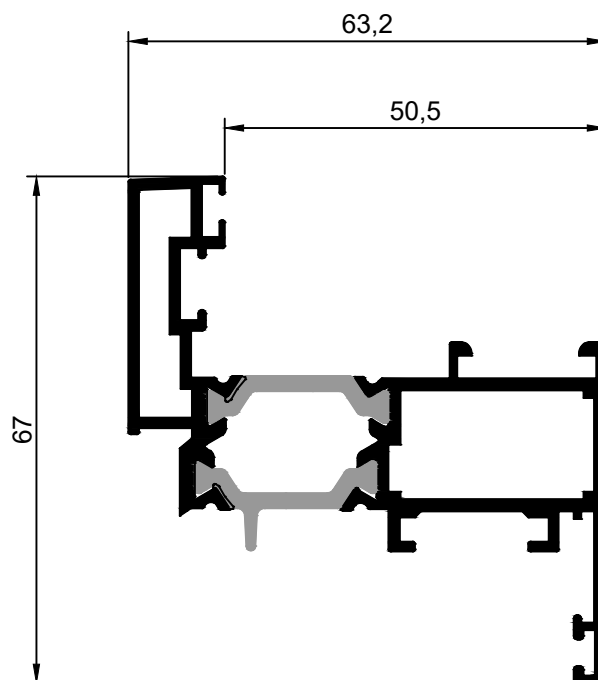

RC.31 Aro Móvel

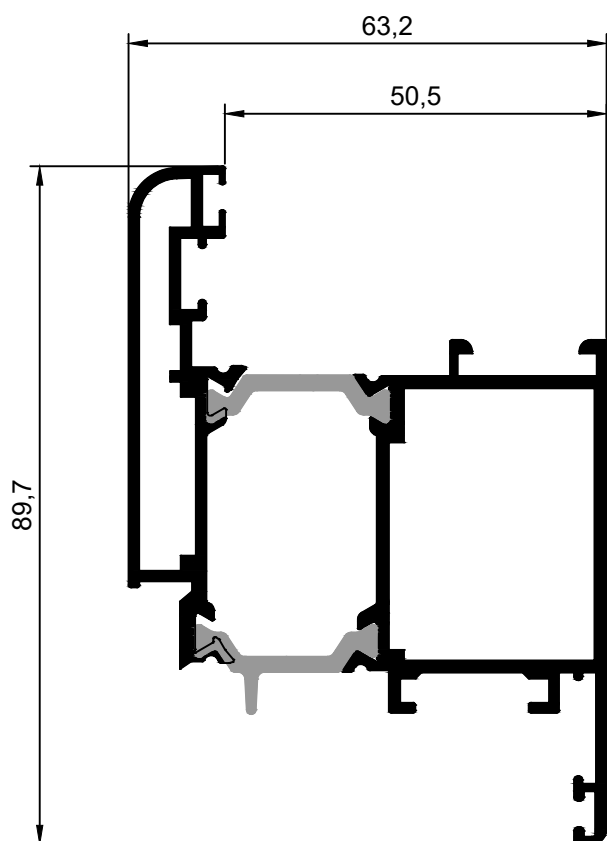

RC.32 Aro Móvel

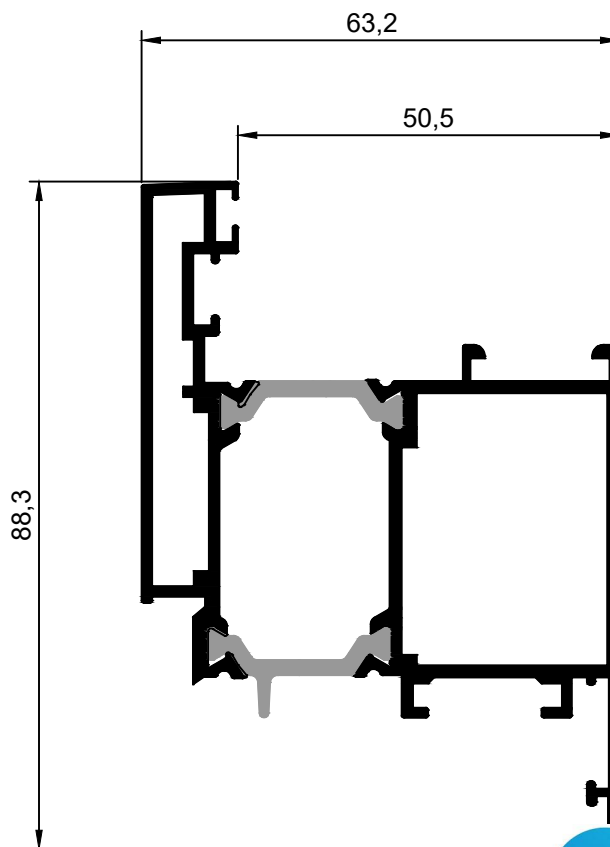

RC.26 Aro Móvel Tradição

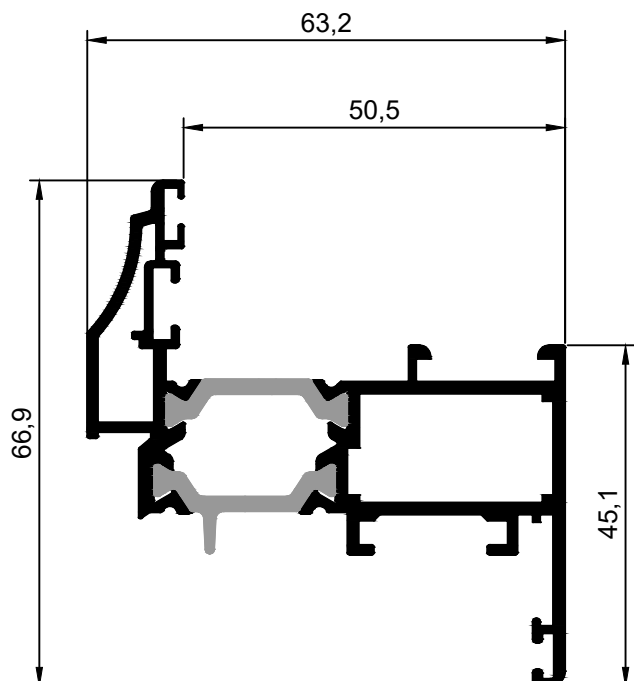

RC.36 Aro Móvel Tradição

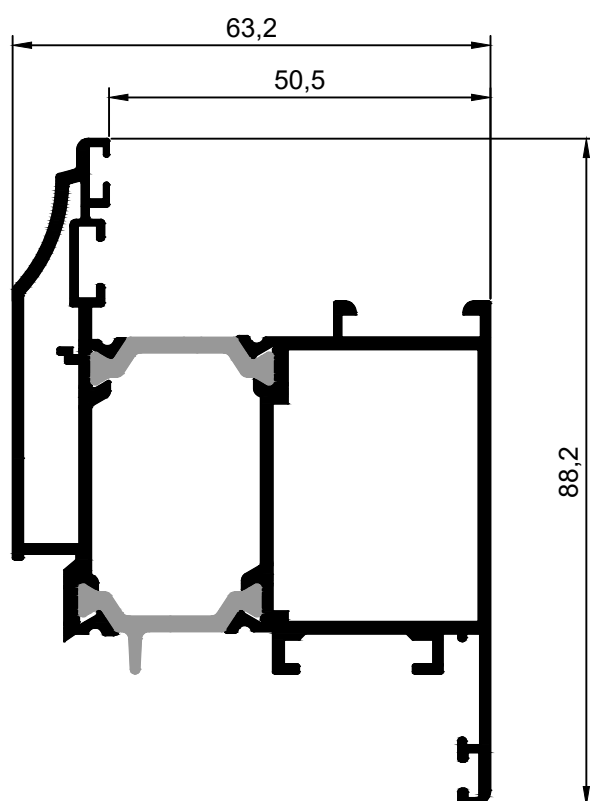

RC.34 Aro Móvel Abert. Exterior

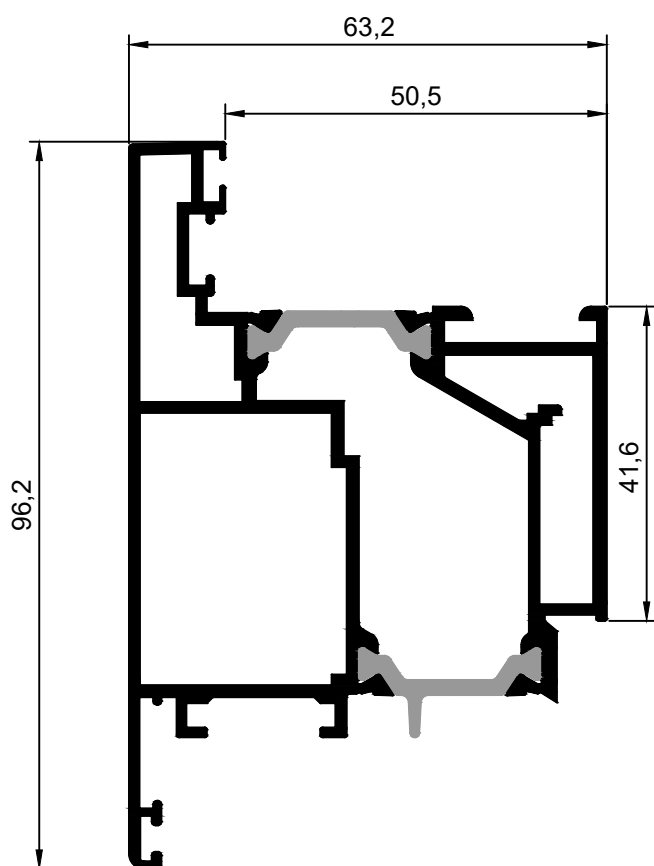

RC.33 Aro Móvel Abert. Exterior

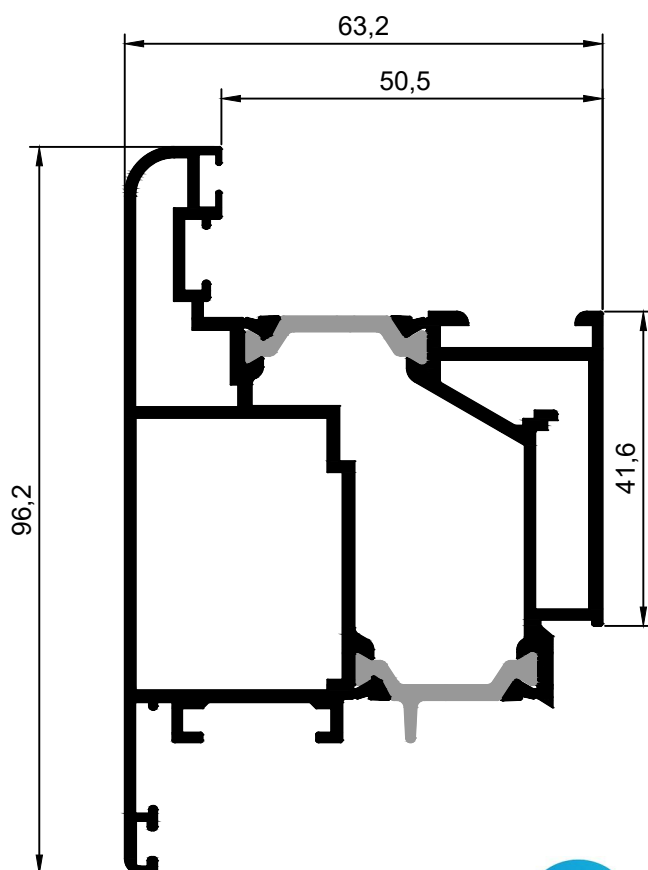

RC.71 *Inversor*

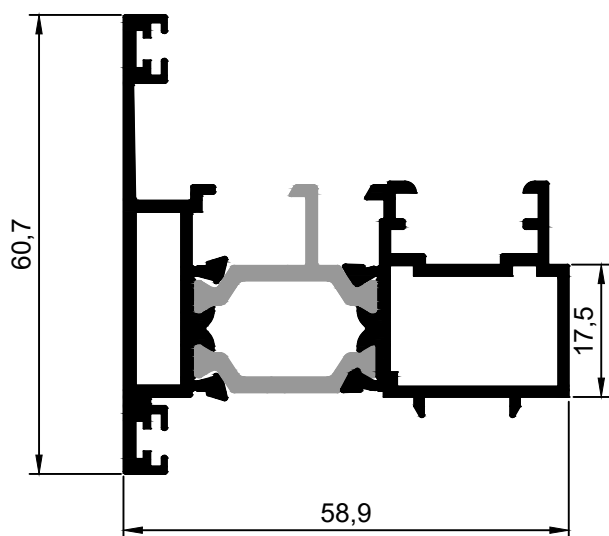

RC.74 *Inversor Aro Fixo*

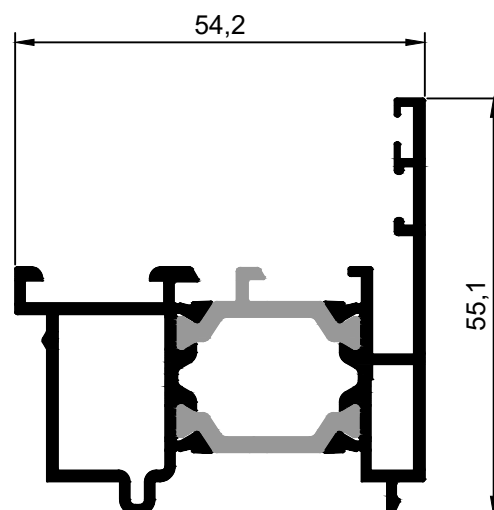

RC.75 *Inversor Pivotante*

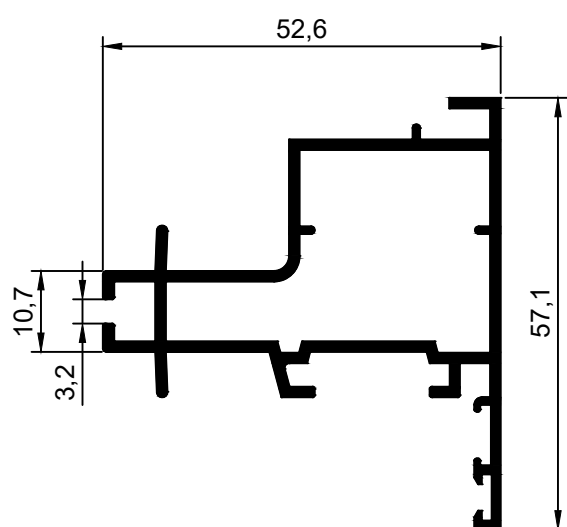

RQ.89 *Perfil Ligação*

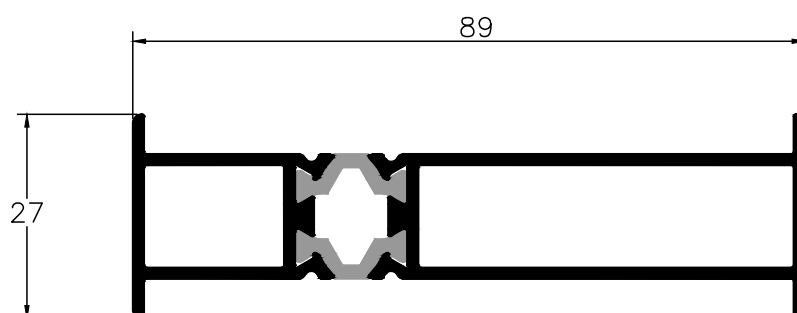
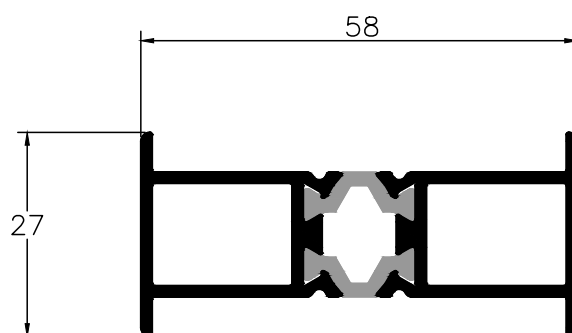

RP.88 *Perfil Ligação*

RC.88 *Perfil Ligação*

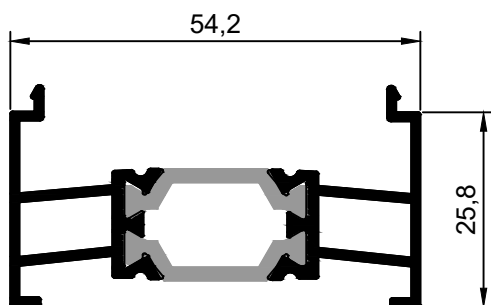

RC.81 *Soleira Condensação*

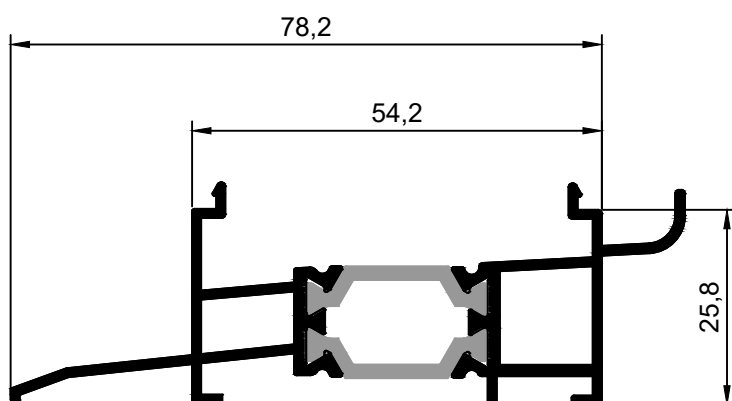
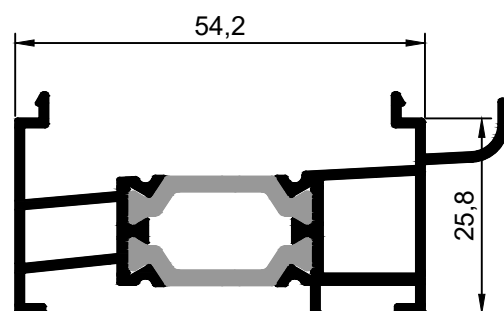

RC.82 *Soleira Condensação*

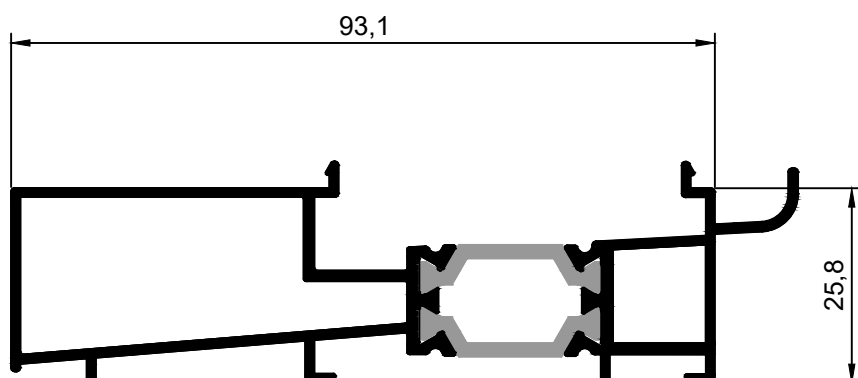

RC.83 *Soleira Condensação*

AQ.87 *Soleira Condensação*

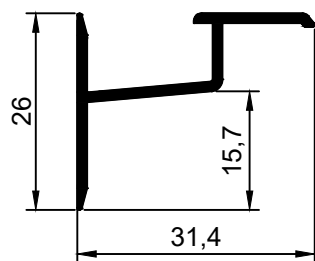

AQ.94 *Vareta Cremone*

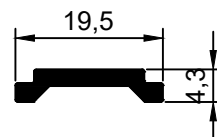

AQ.96 *Pingadeira*

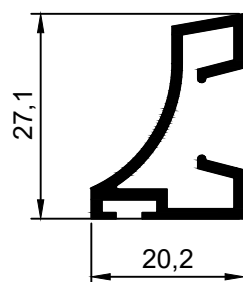

AQ.97 *Clip Pingadeira*

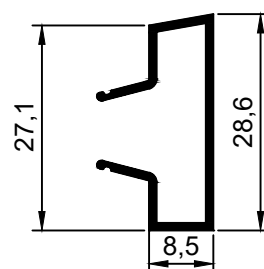

AQ.96A *Pingadeira*

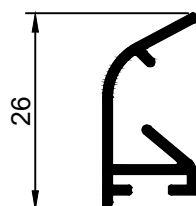

AQ.97A *Clip Pingadeira*

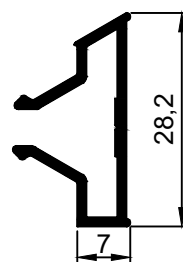

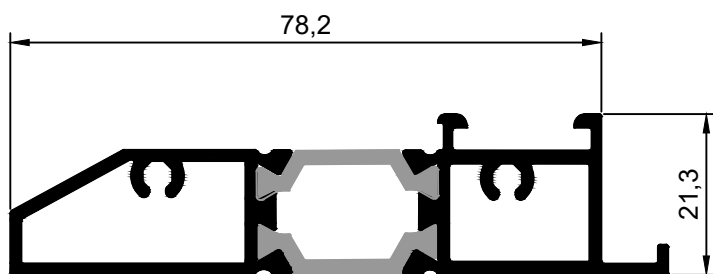

RS.92 *Remate Soleira*

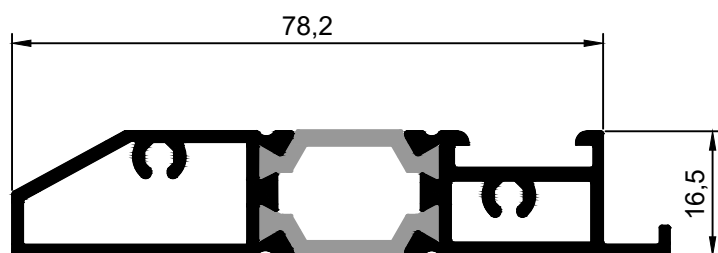

RS.92A *Remate Soleira*

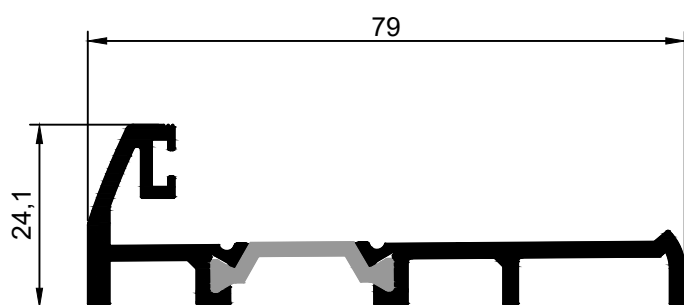

RQ.90 *Remate Soleira*

RQ.85 *Soleira Inferior Portas*

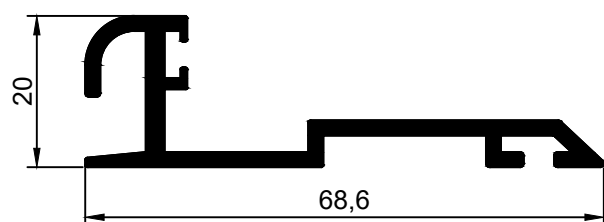

AQ.99 *Bite Inferior Vedação*

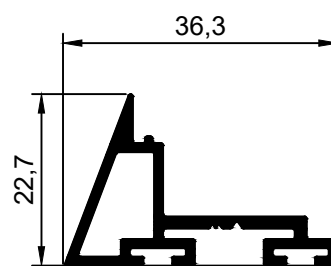

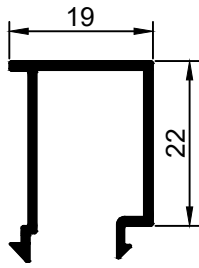

AQ.55 *Bite*

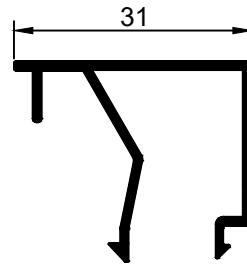

AQ.59 *Bite*

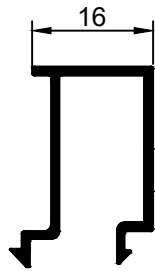

AQ.54 *Bite*

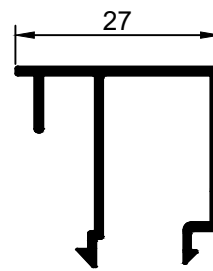

AQ.58 *Bite*

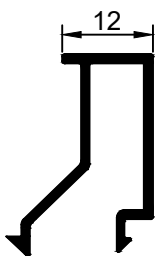

AQ.53 *Bite*

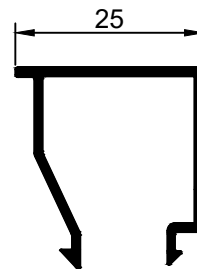

AQ.57 *Bite*

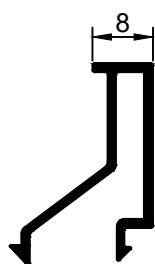

AQ.52 *Bite*

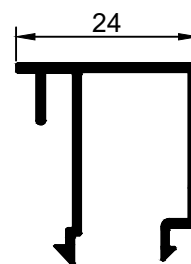

AQ.50 *Bite*

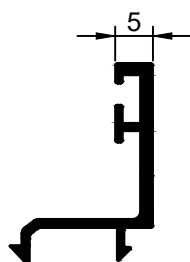

AQ.51 *Bite*

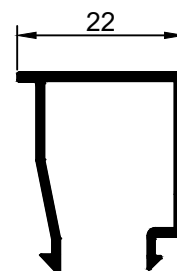

AQ.56 *Bite*

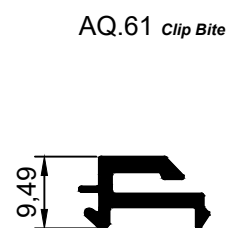
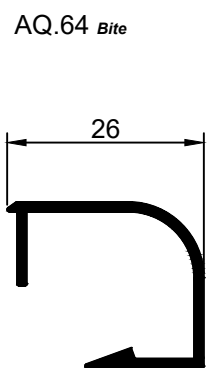
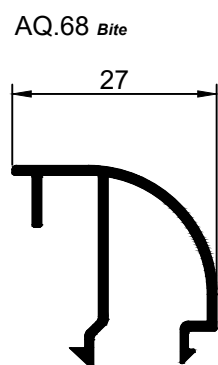
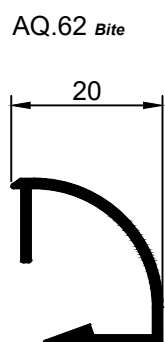
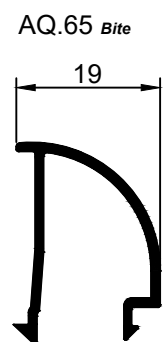
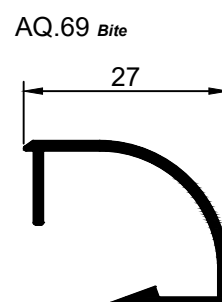
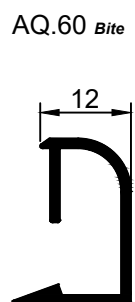
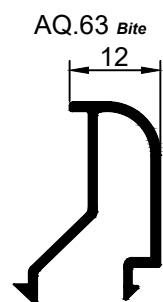

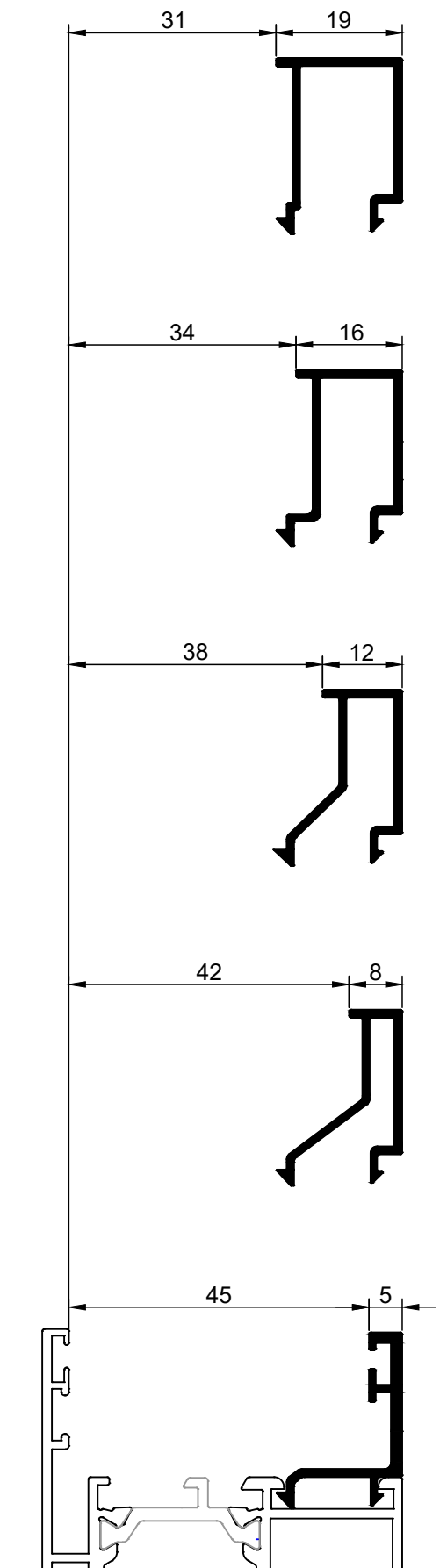

AQ.55 *Bite*

AQ.54 *Bite*

AQ.53 *Bite*

AQ.52 *Bite*

AQ.51 *Bite*

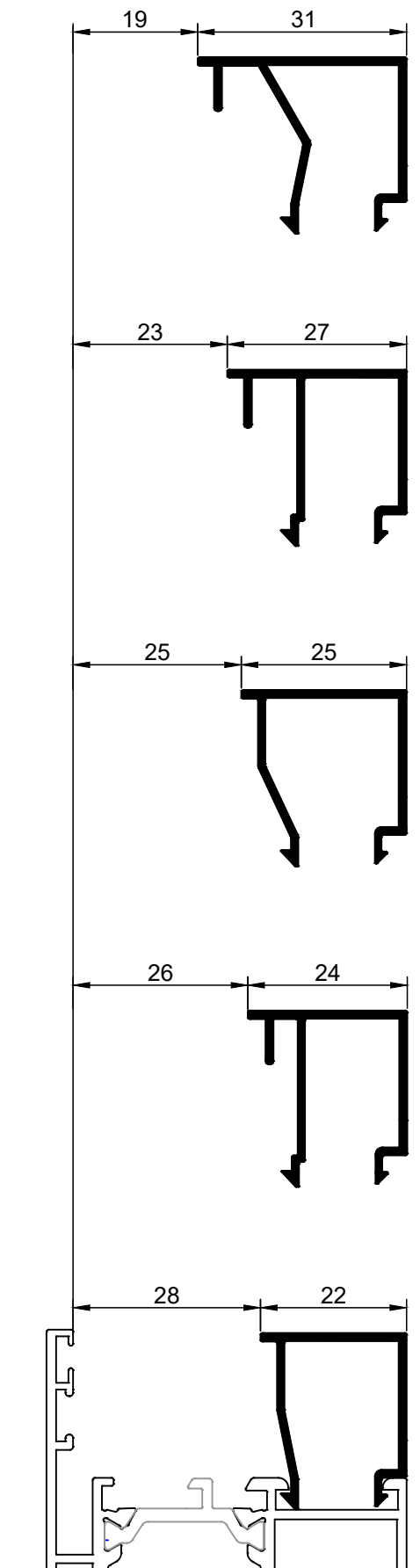

AQ.59 *Bite*

AQ.58 *Bite*

AQ.57 *Bite*

AQ.50 *Bite*

AQ.56 *Bite*

RQ.108 *Remate*

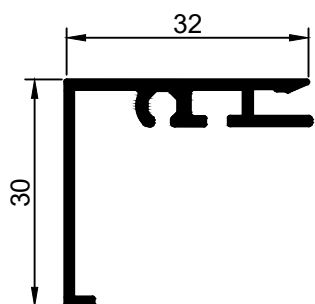

RQ.101 *Remate*

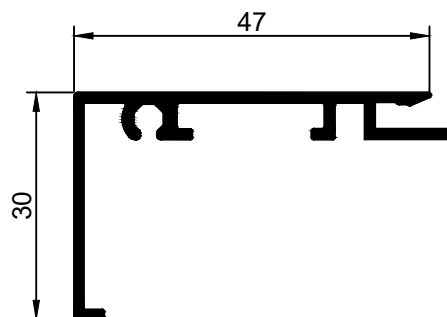

RQ.109 *Remate*

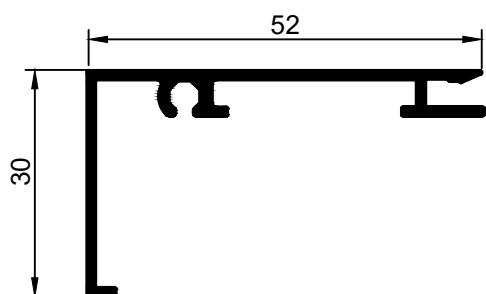

RQ.102 *Remate*

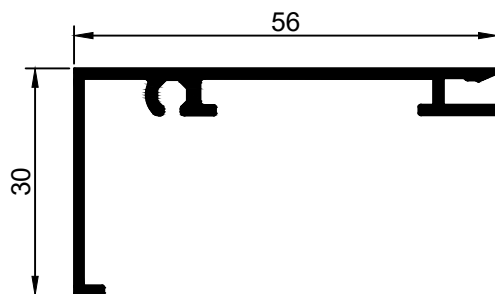

RQ.103 *Remate*

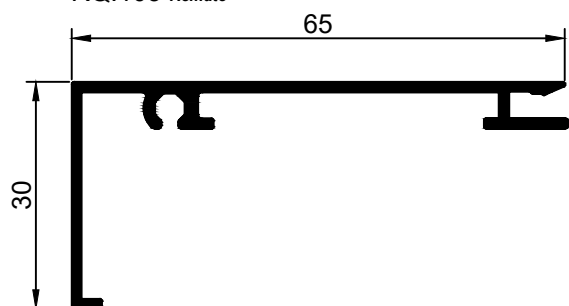

RQ.104 *Remate*

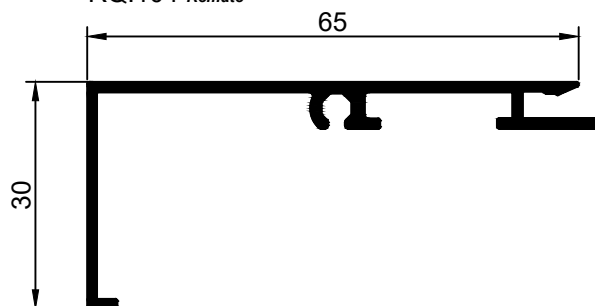

RQ.106 *Remate*

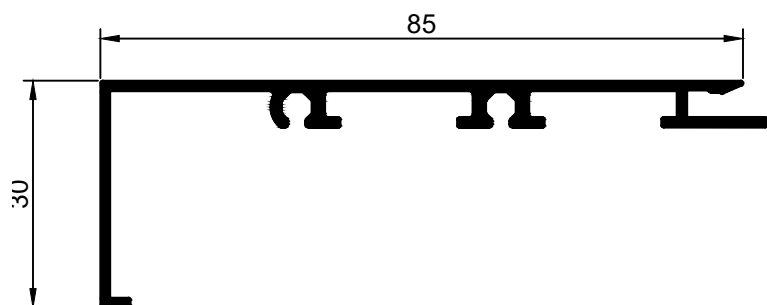

RQ.105 *Remate*

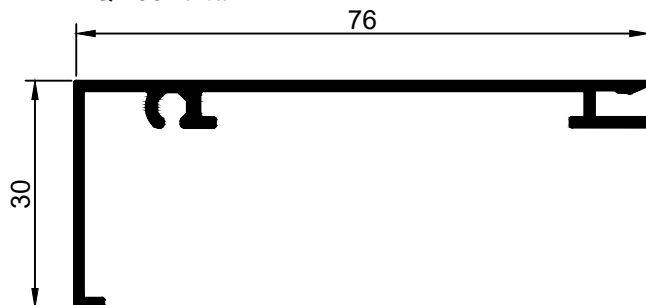

RQ.107 *Remate*

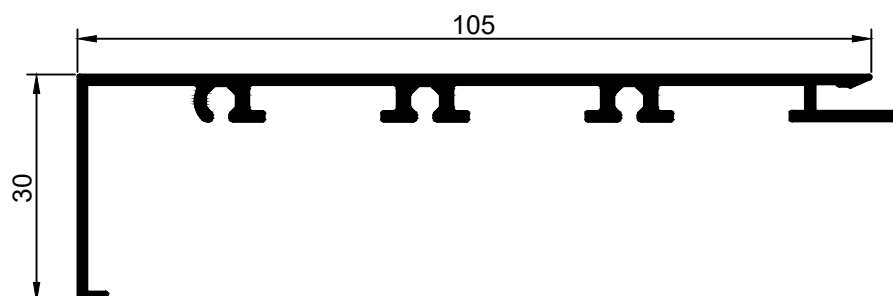

AQ.151 *Remate*

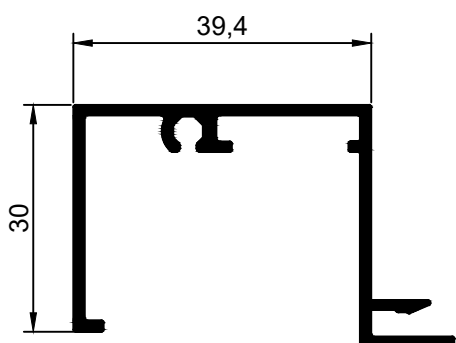

AQ.152 *Remate*

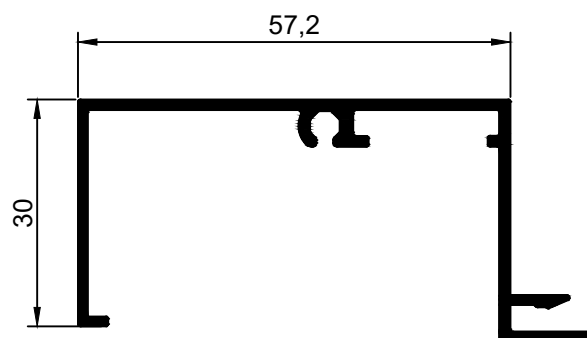

AQ.153 *Remate*

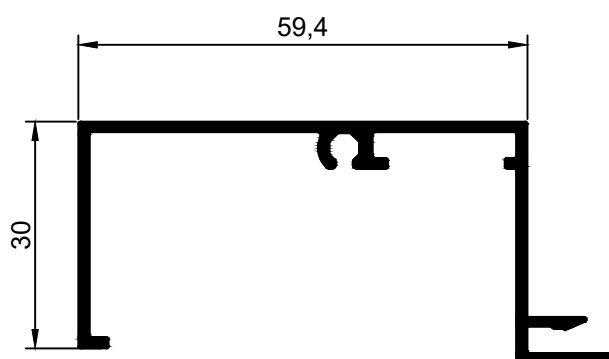

AQ.154 *Remate*

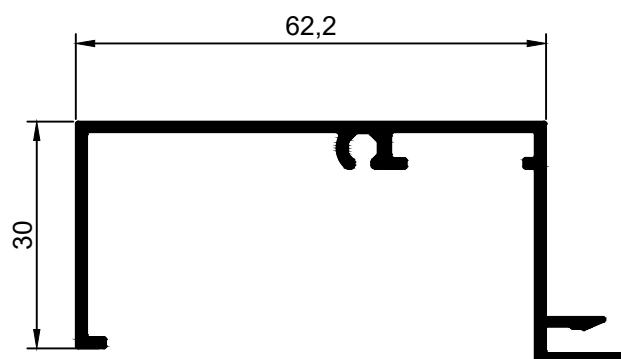

AQ.155 *Remate*

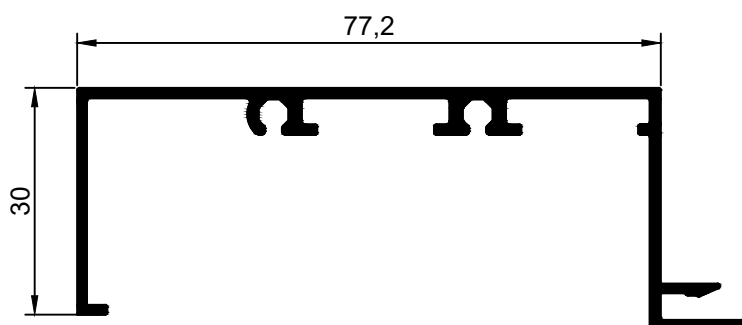

AQ.156 *Remate*

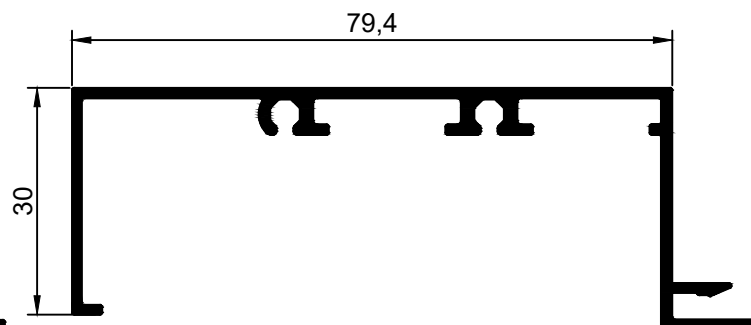

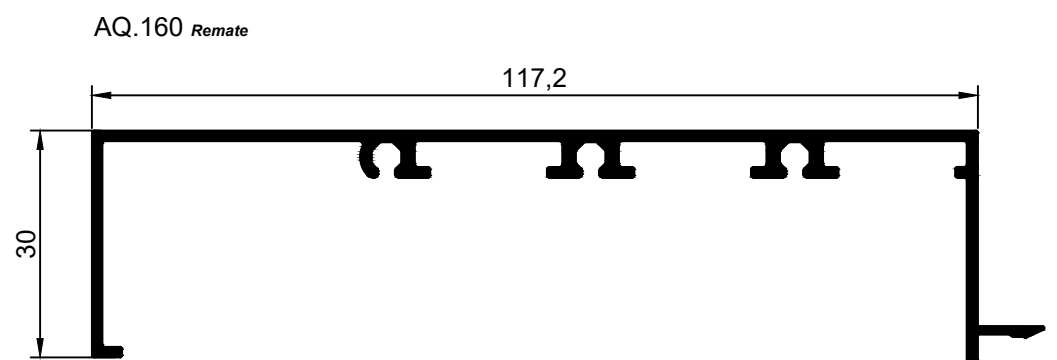
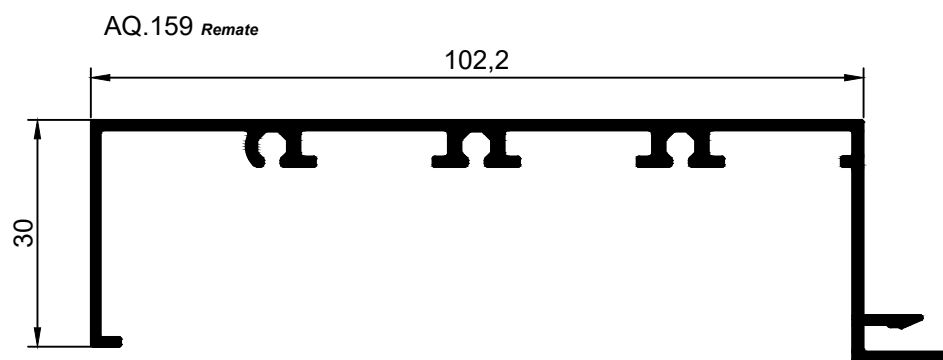
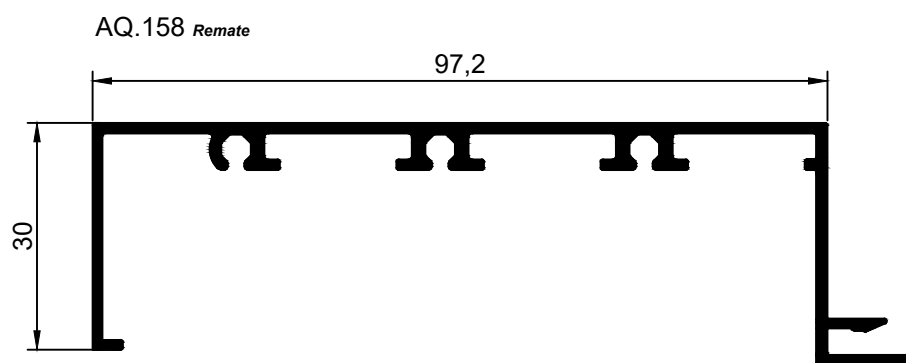
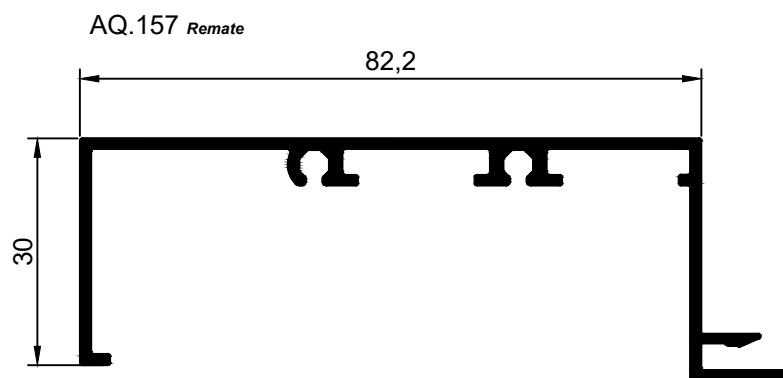

AQ.121 *Remate*

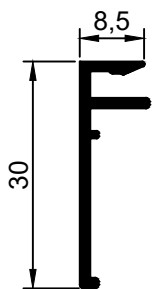

AQ.126 *Remate*

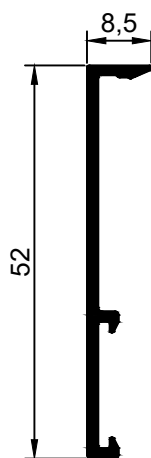

AQ.127 *Remate*

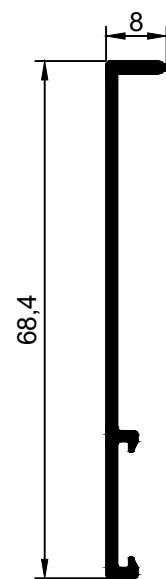

AQ.123 *Remate*

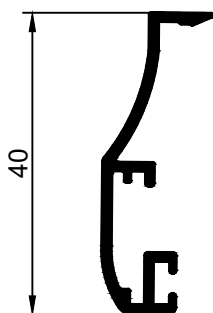

AQ.124 *Remate*

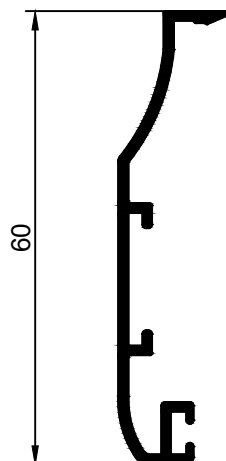

AQ.125 *Remate*

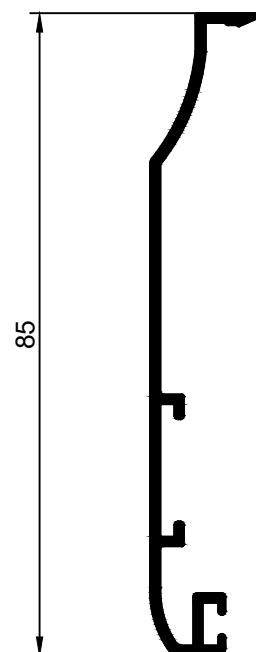

ST.83 *Remate*

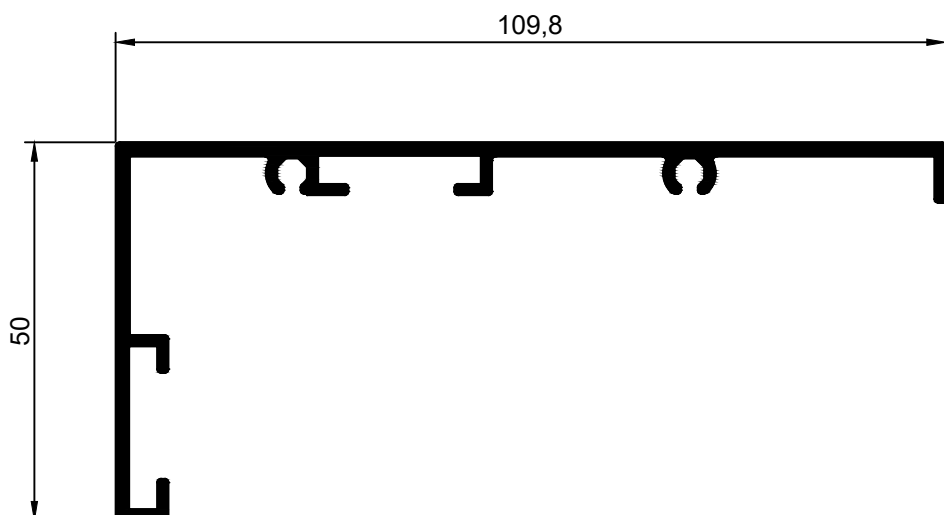

AQ.115 *Remate*

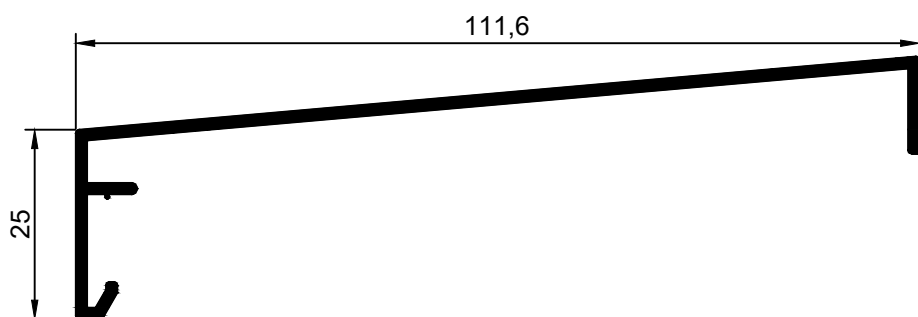

AQ.118 *Remate*

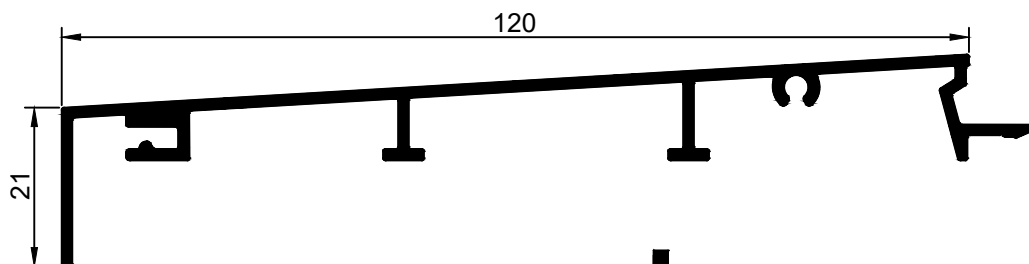

AQ.116 *Esquadro P/ ST.83*

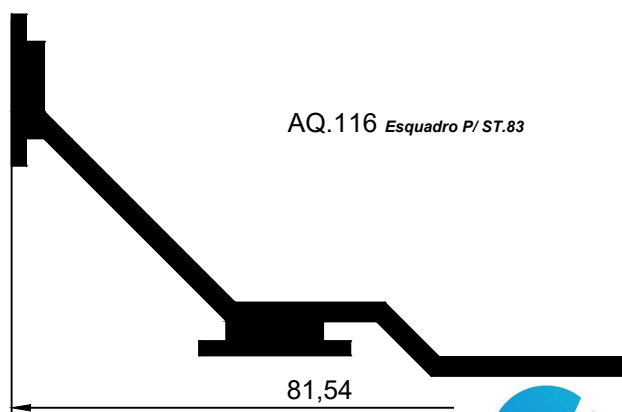

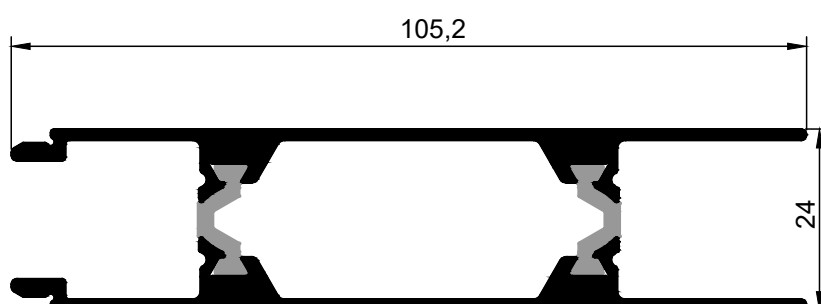
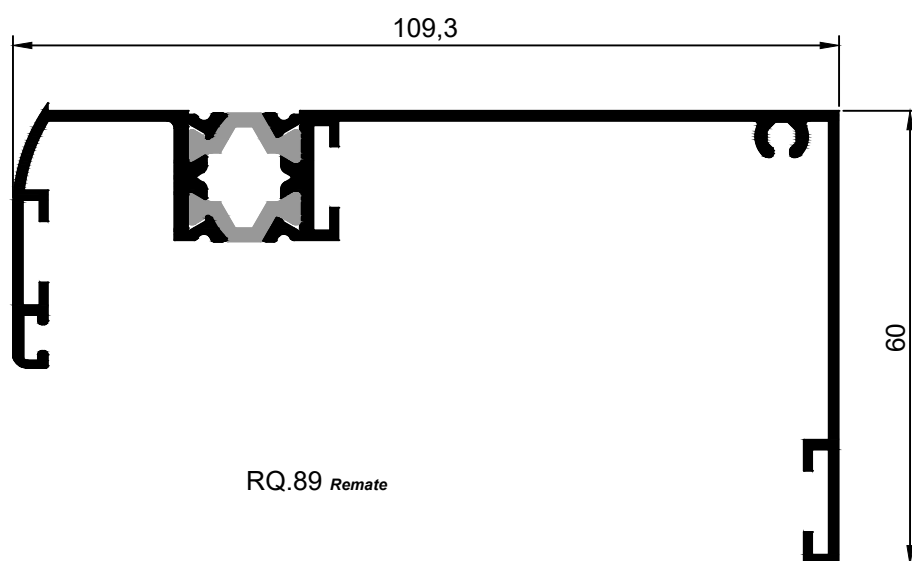
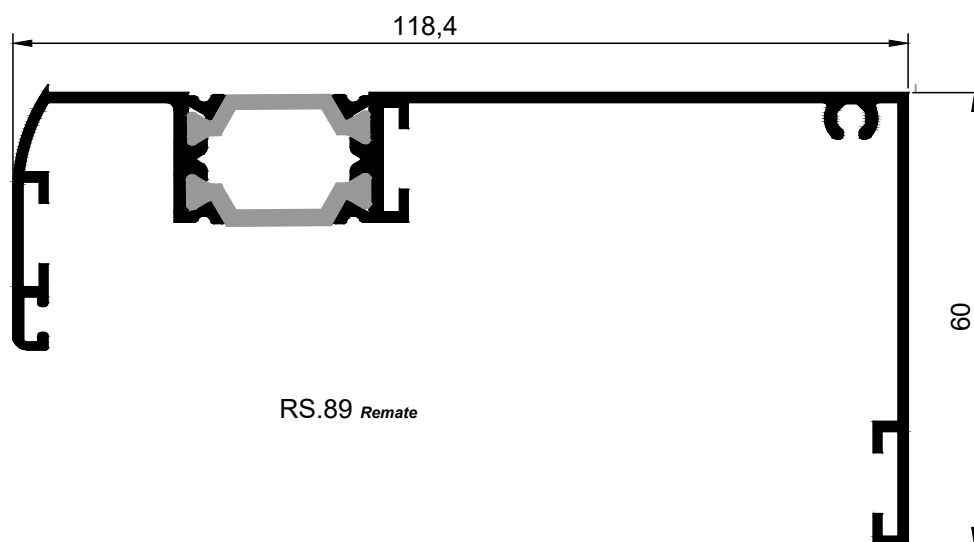

RQ.131 Lâmina

ACESSÓRIOS



ARTIGO	DESCRIÇÃO	APLICAÇÃO	
	ESQ 016 Esquadro NT45 Centrado 18 x 14	RC01	
		RC02	
		RC04	
		RC07	
	ESQ NT45CEN18X31 Esquadro Centrado 18 x 31	RC03	
		RC06	
		RC08	
		RC10	
		RC11	
	ESQ NT45CEN24X14 Esquadro Centrado 24 x 14	RC21	
		RC22	
		RC26	
	ESQ NT4 Esquadro Centrado 25 x 34.5	RC31	
		RC32	
		RC33	
		RC34	
		RC36	
	ESQ 180 Esquadro Alinhamento 5.3 x 10.7	RC01	RC26
		RC02	
		RC04	
		RC07	
		RC21	
		RC22	
	ESQ 182 Esquadro Alinhamento 5.3 x 24.7	RC03	RC36
		RC06	
		RC31	
		RC32	
		RC33	
		RC34	
	ES1 092 Pino P/Esq.180/1/2 Mont		

ARTIGO	DESCRIÇÃO	APLICAÇÃO	
	ESQ L10417	RQ92	
	Esquadro União	RQ92A	
		RS92	
		RS92A	
	ESQ UNS200G	RC11	
	Esquadro União P/T Grande	RC19	
	ESQ ALINH ZAMAK Esquadro de Alinhamento Zamak	RC21	RC34
		RC22	RC36
		RC26	RC08
		RC31	RC10
		RC32	
		RC33	
	ESQ ALINH14 2X1 2P Esquadro de Alinhamento 14,2 x 1,2	RC21	RC34
		RC22	RC36
		RC26	
		RC31	
		RC32	
		RC33	
	ESQ ALINH7 5 1X1 2 Esquadro de Alinhamento 7.5 x 1.2	RC01	RC11
		RC02	RC19
		RC03	RC74
		RC04	RC75
		RC06	
		RC07	
	KIT 0225600K Kit Cremone 1 Folha		
	KIT 02258000K Kit Cremone 2 Folha		

ARTIGO	DESCRIÇÃO	APLICAÇÃO
	Fecho 49041 Fecho CE Pequeno 2ªFolha Zamak	
	Fecho 49048 Fecho CE Medio 2ªFolha Zamak	
	Fecho 49054 Fecho CE Grande 2ªFolha Zamak	
	DOB 00120 Dobradiça Camara Europeia 2F	EXISTEM NAS CORES: Branco Preto Prata
	DOB 00151 Dobradiça Camara Europeia 3F	EXISTEM NAS CORES: Branco Preto Prata
	DOB 8020 Dobradiça Porta Pesada	EXISTEM NAS CORES: Branco Preto Prata Bruto
	DOB 535 Dobradiça 535 Porta Flash	EXISTEM NAS CORES: Branco Preto Prata Bruto

ARTIGO	DESCRIÇÃO	APLICAÇÃO
--------	-----------	-----------



FECHA 6FAE630G62801

Fechadura Prumo 730/30 c/cilindro

FECHA 6FAE630062801

Fechadura Prumo 730/35 c/cilindro



FECHA 6FAE67L062801

Fechadura Tripla 755/30 c/cilindro

Fechadura Tripla 755/35 c/cilindro



FECHO CG0107

Fecho Bandeira c/afinação Cam.Europeia











FECHO D6030

Fecho Bandeira
perfis tradição

ARTIGO	DESCRIÇÃO	APLICAÇÃO
	COMP 10631 - Compasso Grande	
	COMP 10630 - Compasso Pequeno	
	COMP 12301CE Compasso Projectante EASY Aço Inox	
	COMP 1210 INOX Compasso Projectante	
	FECHO 01024 Fecho Cremone Prima (Rapid 104)	
	FECHO 01007 Fecho Cremona Supernova	
	KIT 02245000 Kit Cremone Abertura Exterior	
	OB 04704000 - Oscilo-Batente	
	OB 04711500 - Oscilo-Batente Tradição Giesse	
	OB 3420G - Oscilo-Batente Ween	
	OB 3520 251 - Oscilo-Batente Tradição Master	

ARTIGO	DESCRIÇÃO	APLICAÇÃO
	JP 6401 - Acessório de conexão P/Jan.Proj.	
	JP 6006 1 - Cremone p/Janela Projectante	
	JP 4241 - Perno de Fecho P/Janela Projectante	
	JP 4212 2 - Encontro Aste Simples P/Jan.Proj.	
	JP 3620 3 - Kit Fecho Janela Projectante	
	OB 04770000K - Angulo Suplementar P/OB Giesse	
	OB 3400G 31 - Fecho complementar OB Master	
	FECHO 04282000K - Fecho 2ªFolha OB Giesse	
	FECHO 3520 34 - Fecho 2ªFolha OB Master	
	DOB 04718 - Dobradica 2ª Folha O/B Giesse	
	DOB 3520 71 - Dobradiça 2ª Folha O/B Master	
	PUXA 02472	EXISTEM NAS CORES:
	Puxador Muleta	Branco Preto Prata
	FECHO 050612601 Fecho de Lingueta 7400	
	Ponto Fecho	

ARTIGO	DESCRIÇÃO	APLICAÇÃO
	TOP 2077 11RC Topo P/RC.71	RC.71
	TOP L20633 Topo AQ99	AQ99
	TOP 353 Topo Pingadeira	AQ96
	VD 6016 Vedante Central EPDM RC/RQ	
	VD P1228 10 ES Vedante Batente Aro EPDM	Aplicar nos Aros Móveis
	VD 6068 Vedante Batente EPDM Aro Fixo RS/RQ	Aplicar Aro Fixo
	VD L20713 Vedante remate AQ99	AQ99
	VD L20723 Vedante anti-derrapante	RQ92 RS92A RQ92A RS92

ARTIGO

DESCRIÇÃO

APLICAÇÃO

Diagramas

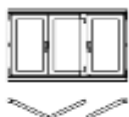

2 + 1

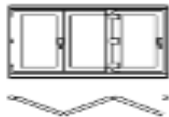

3

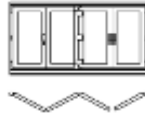

3 + 1

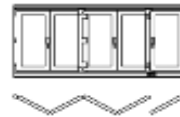

4 + 1

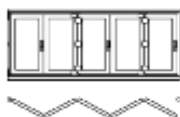

5



3 + 2

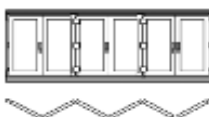

6

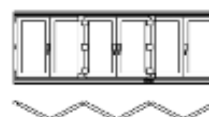

3 + 3

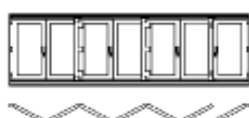

6 + 1

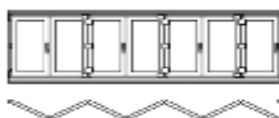

7

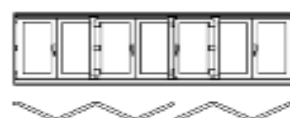

4 + 3

Importante:

Largura Mínima Por Folha:	350mm
Largura Máxima Por Folha:	900mm
Altura Mínima Por Folha:	850mm
Altura Máxima Por Folha:	2400mm
Peso Máximo Por Folha:	80 Kg

ARTIGO

DESCRIÇÃO

APLICAÇÃO

Conjunto Oscilo-Paralela

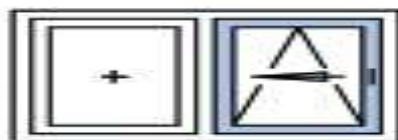
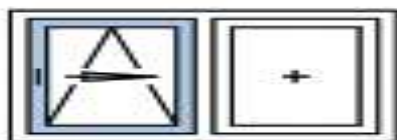

Importante:

Altura Mínima: 850mm

Altura Máxima: 2400mm

Peso Máximo: 150 Kg

FORMENORES TÉCNICOS



SÉRIE RC

FIXO

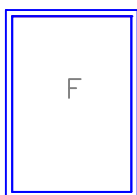

corte vertical
escala: 1/2

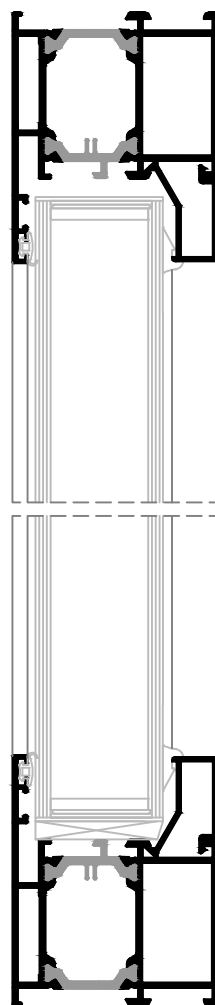

RC.03

corte horizontal
escala: 1/2

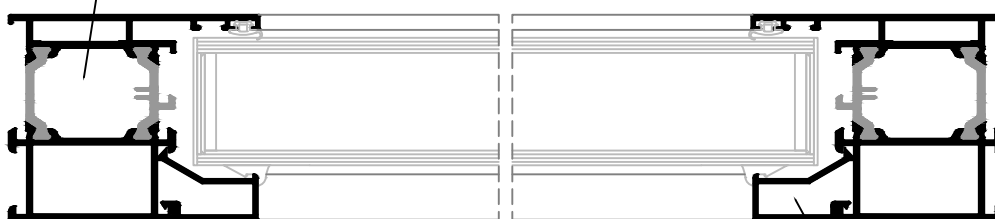

AQ.53

SÉRIE RC
BASCULANTE

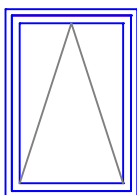

corte vertical
escala: 1/2

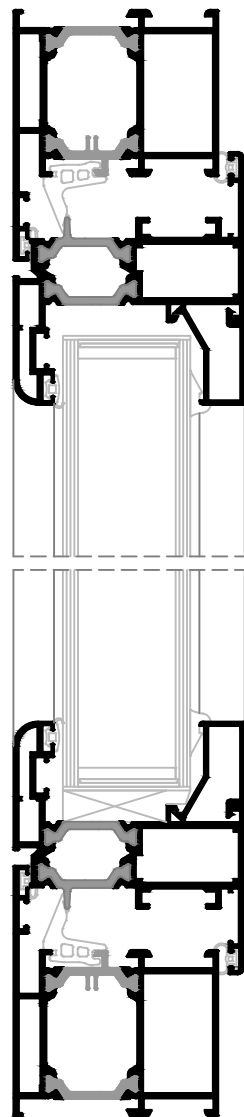

corte horizontal
escala: 1/2

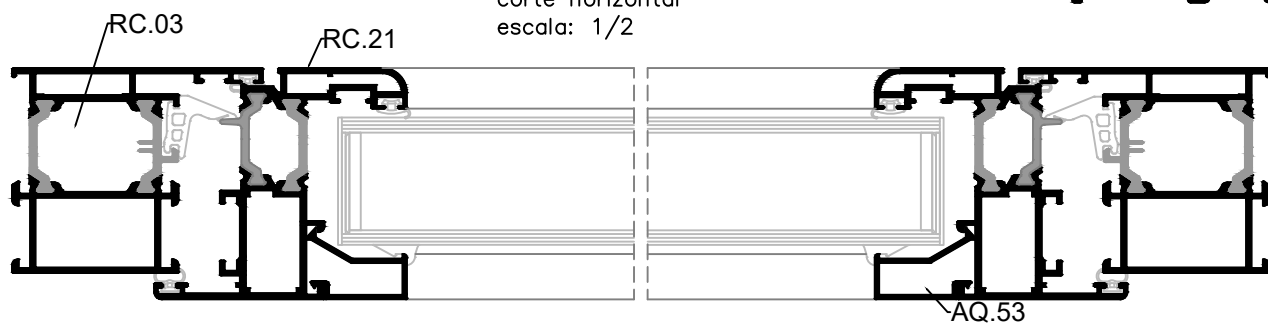

SÉRIE RC

ABRIR 1 FOLHA

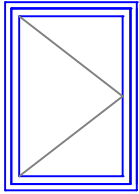

corte vertical
escala: 1/2

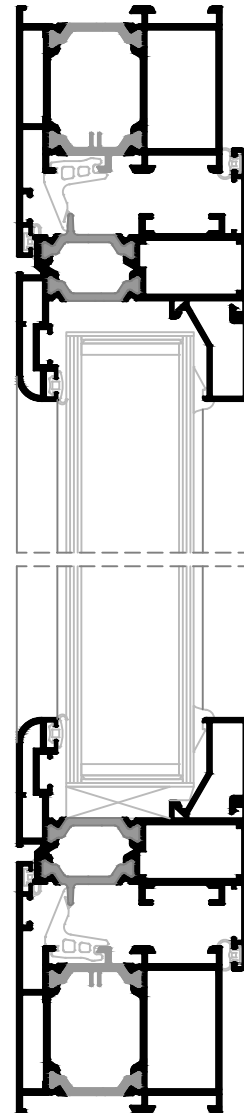

corte horizontal
escala: 1/2

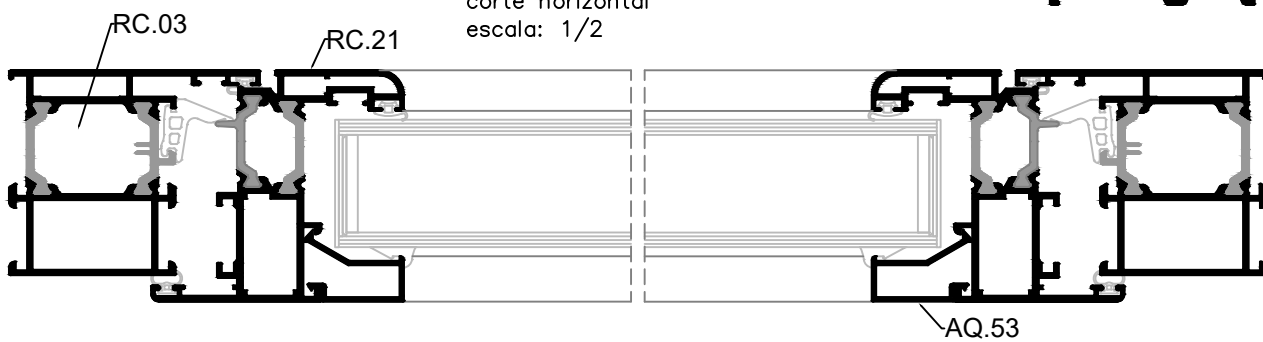

SÉRIE RC

ABRIR 1 FOLHA C/ OSCILO + FIXO

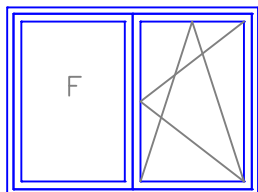

corte vertical
escala: 1/2

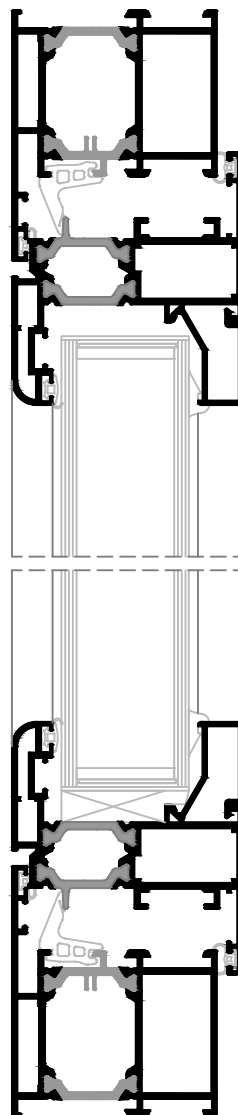

corte horizontal
escala: 1/2

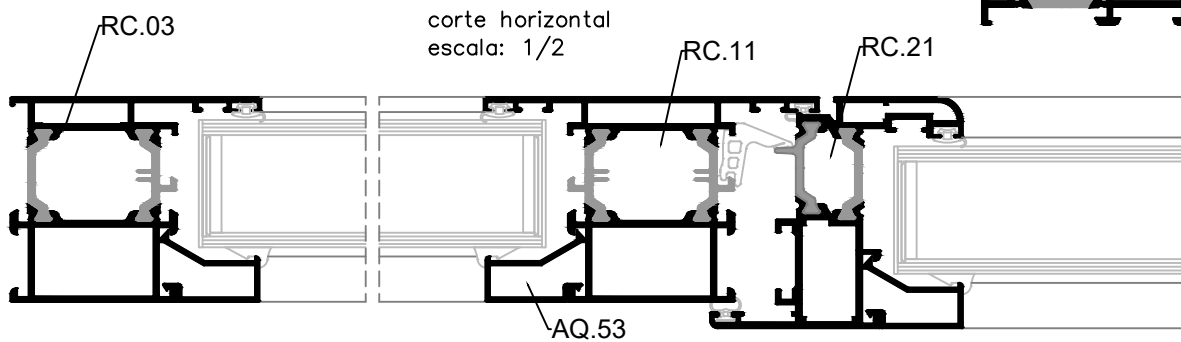

SÉRIE RC

ABRIR 2 FOLHAS

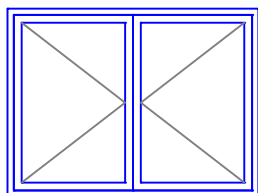

corte vertical
escala: 1/2

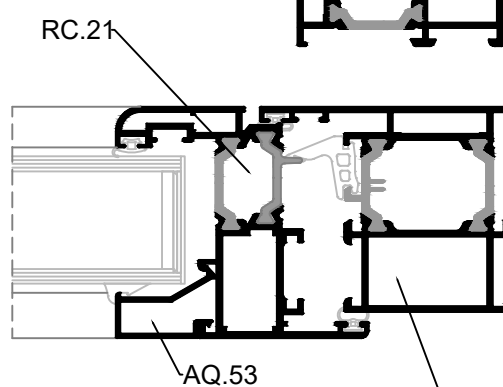
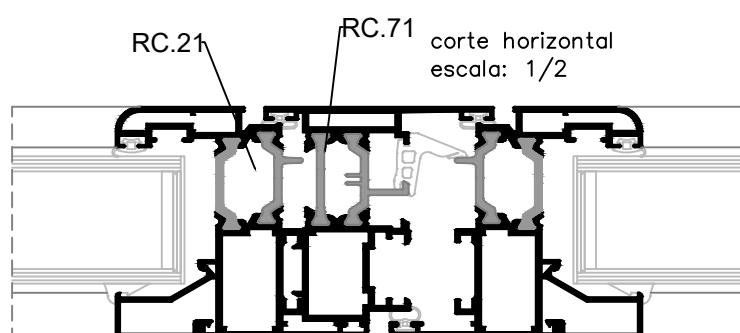
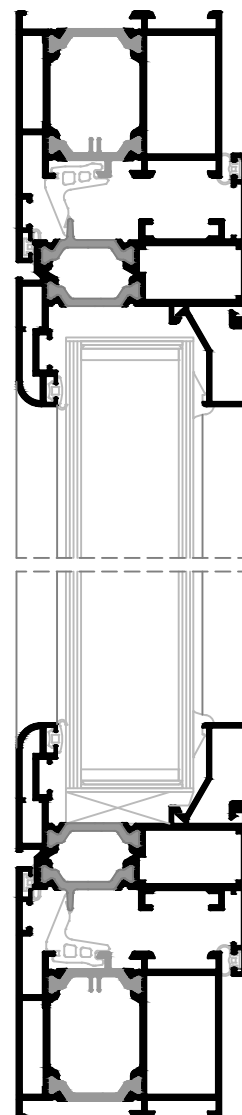

SÉRIE RC
PROJECTANTE

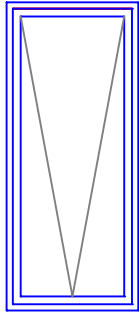

corte vertical
escala: 1/2

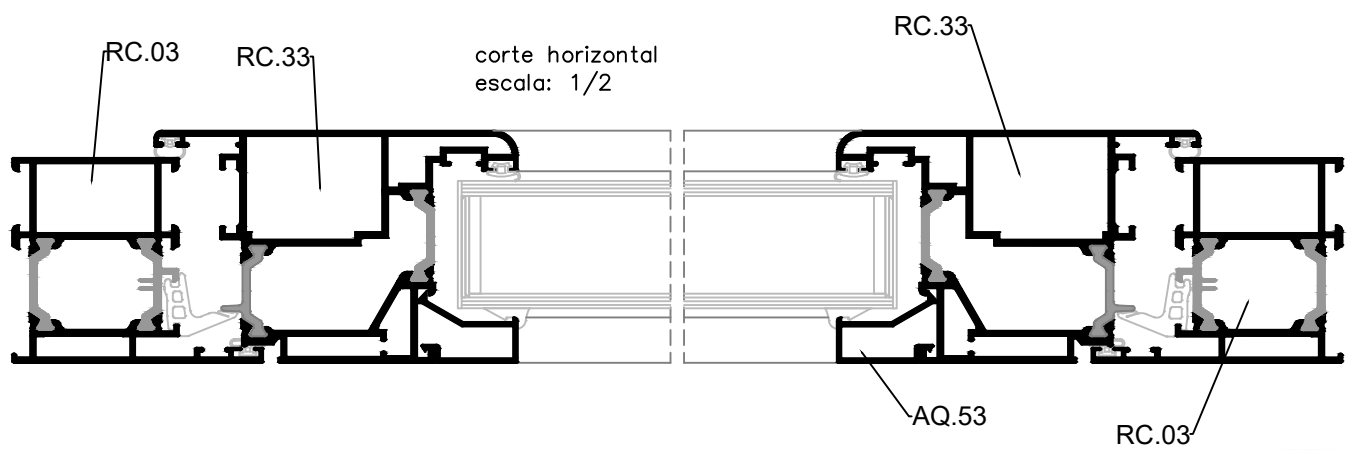
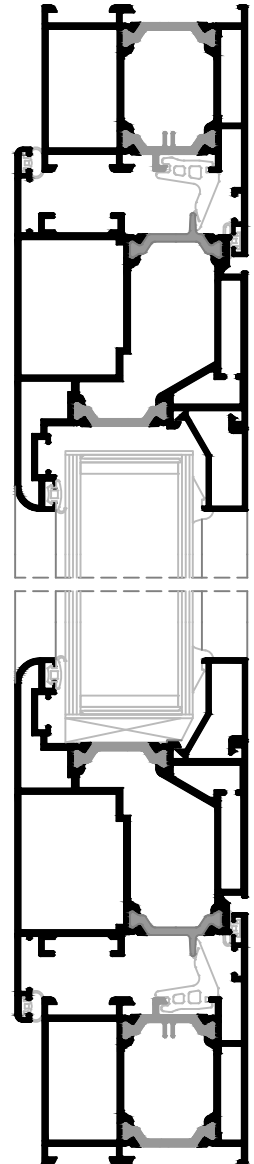

SÉRIE RC

PORTA SACADA 2FLS C/ OSCILO

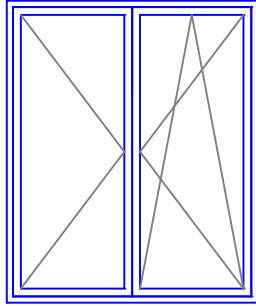

corte vertical
escala: 1/2

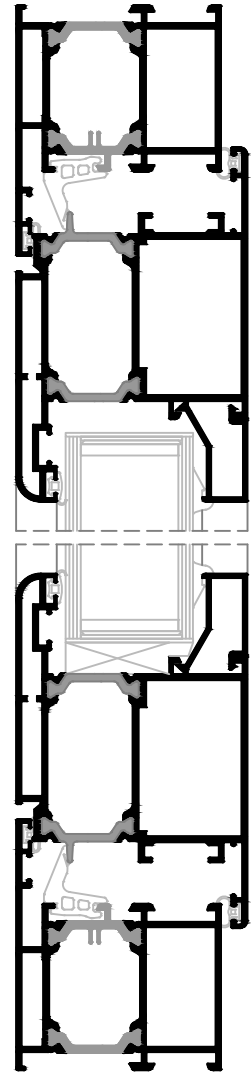

RC.31

corte horizontal
escala: 1/2

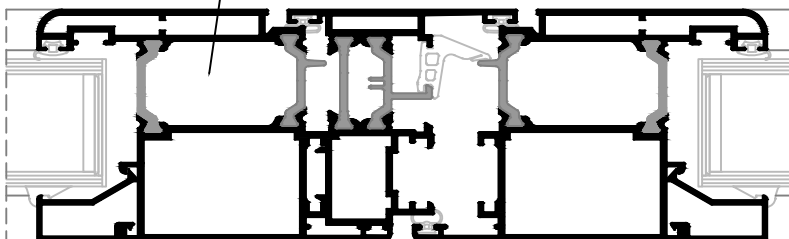

RC.31

RC.03

AQ.53

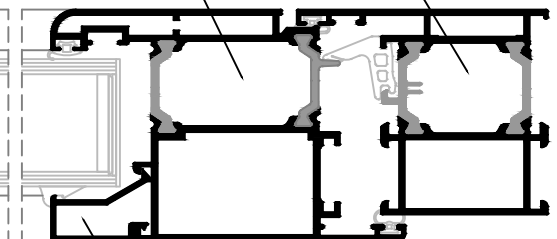

SÉRIE RC

PORTA ABRIR 1 FL C/ REMATE INFERIOR

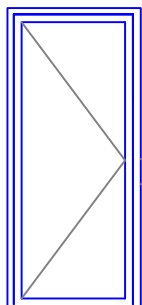

corte vertical
escala: 1/2

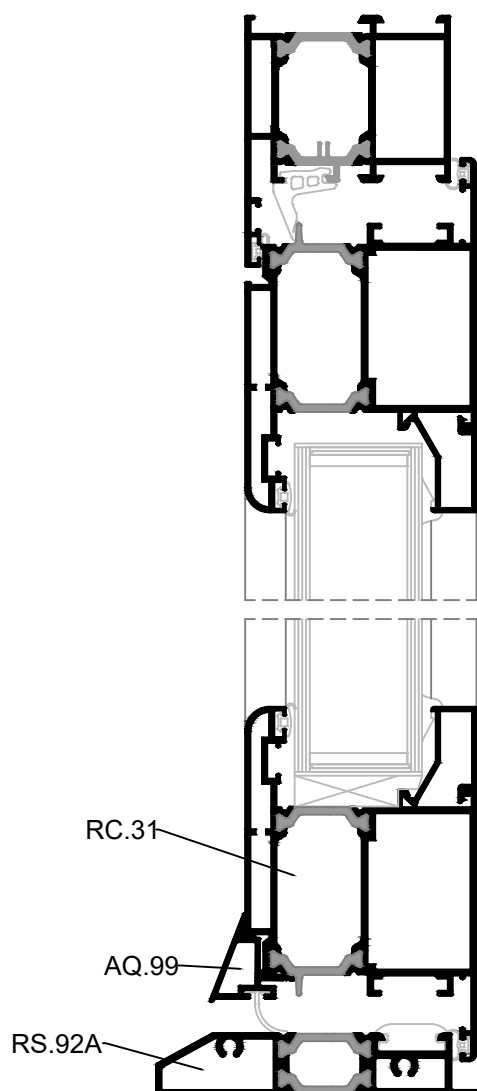

corte horizontal
escala: 1/2

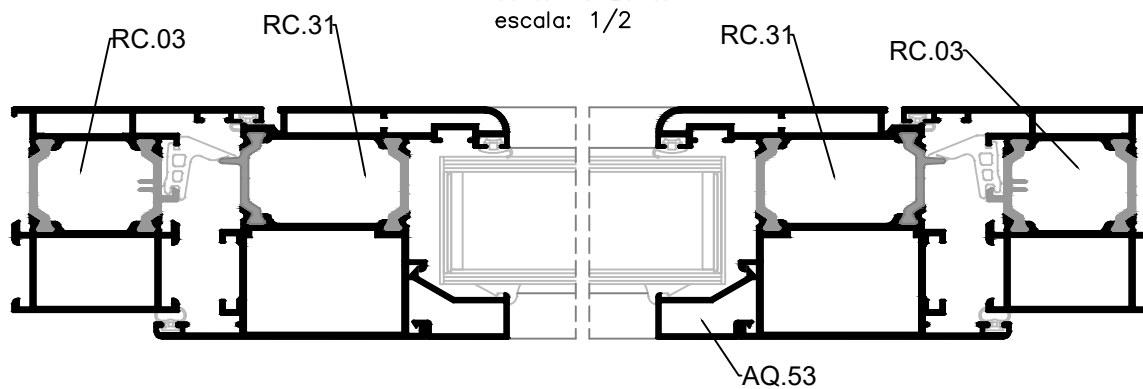

SÉRIE RC

PORTA ABRIR 1 FL

corte vertical
escala: 1/2

